

ALP1120/A1

LED panel for rolling stock

- Viewing area (572 × 252) mm
- LED colour – yellow
- Resolution (144 × 64) pixels
- Communication interface RS485 with GS
- Power supply 24 V DC
- Complies UIC176
- Designed in accordance with EN 50155:2007

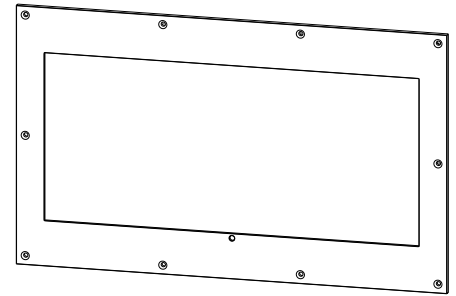

TECHNICAL DATA

Display area	(572 × 252) mm
Resolution	(144 × 64) pixels
LED pitch	4 mm
LED colour	Yellow, 590 nm typ.
Brightness	Min. 800 cd/m ²
Viewing angle	70 ° *)
Light sensor	1 ×
Function	Measuring of ambient light
RS485	1 ×
Galv. separation, dielectric strength	Yes, 500 V AC /1 minute **)
Connection point	WAGO 231-636/019-000 ##)
Geographic addressing	Separate cable
Number of bits	4
Connection point	WAGO 231-635/019-000
Power supply	16.8 V to 33.6 V DC
Nominal power supply voltage	24 V DC
Maximum power consumption	15 A at 24 V DC
Peak inrush current	10 A #)
Connection point	WAGO 231-636/019-000 ##)
Others	
Mechanical construction	Steel sheet metal cover, duralumin panel
Colour of mechanics	Grey / RAL 7035
Mounting	On wall, 10 × hole Ø 7
Cover protection rate	IP67
Operating temperature	-40 °C to 70 °C
Storage temperature	-40 °C to 70 °C
Maximum ambient humidity	< 95 % non-condensing
Weight	9,3 kg ±5 %
Dimensions (w × h × d)	(667 × 401 × 41) mm
Expected MTBF	> 150 000 h

*) Decline in brightness from the line of observation angle to 50 %.

**) Galvanic separation must not be used for dangerous voltage separation.

#) Inrush peak current duration is less than 10 ms.

##) Power supply and RS485 communication share common connector.

ORDERING INFORMATION

ALP1120/A1	LED panel, connector counterparts, Routine testing protocol, Insulation testing protocol, quality and completion certificate.
-------------------	---

RECOMMENDED DRAWING SYMBOL

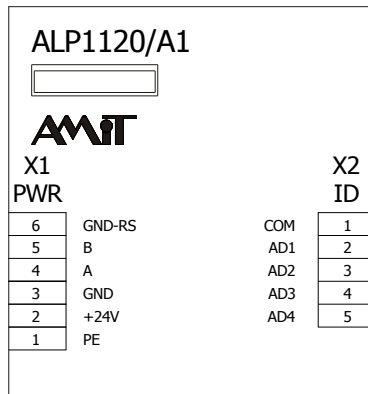

TERMINAL'S IDENTIFICATION

Connector	PIN	Signal	Signal description
X1 PWR	1	PE	Unit chassis
	2	Vcc	Power supply, +24 V DC
	3	GND	Power supply, Ground
	4	A	RS485, signal A
	5	B	RS485, signal B
	6	GND-RS	RS485, ground

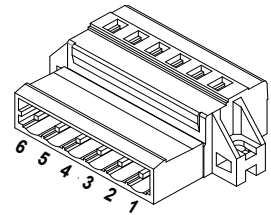

Connector	PIN	Signal	Signal description
X2 ID	1	COM	Common addressing pin
	2	AD1	Addressing pin 1
	3	AD2	Addressing pin 2
	4	AD3	Addressing pin 3
	5	AD4	Addressing pin 4

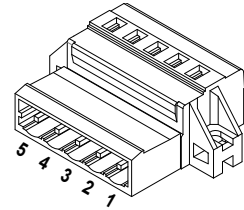

PANEL DIMENTIONS

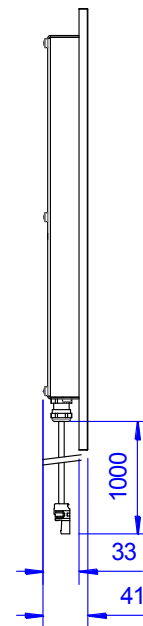
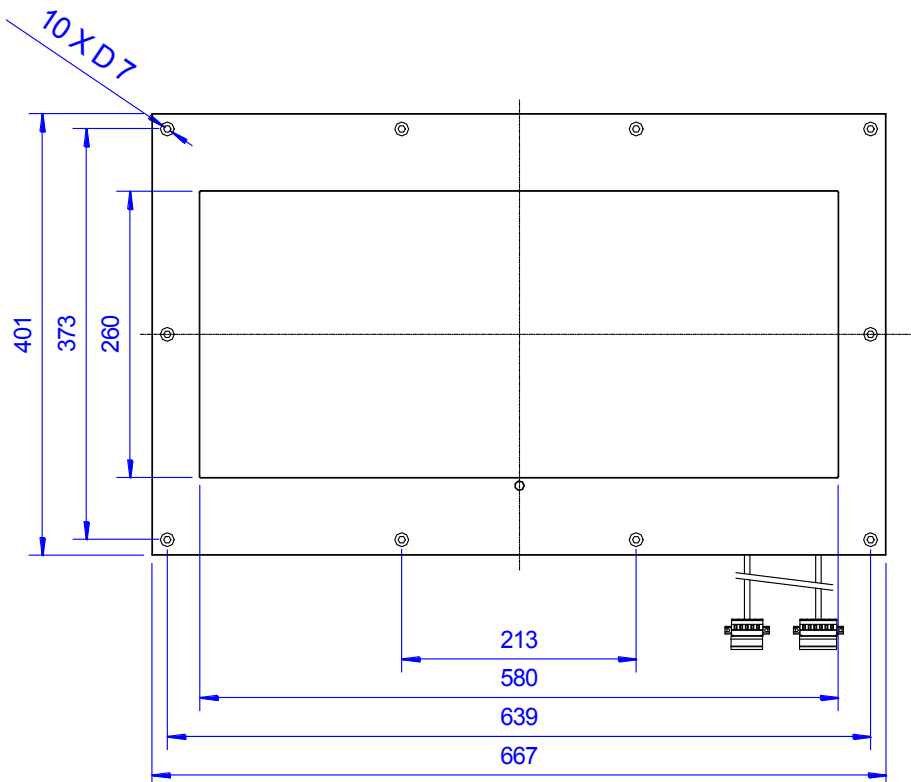

Data provided in this datasheet are only informative. Detailed information can be found in operational manual ([alp1120a1_g_en_xxx.pdf](#)). Documentation and examples can be downloaded from www.amit-transportation.cz web site.